

NOTES

- All natural water drainageways shall not be changed or altered in any way except as approved by the Pima County Board of Supervisors.
- Fifteen foot gas line easements are herein dedicated along all subdivision boundary lines and 7'-6" gas line easements are dedicated along each side of all other lot lines except road right of way lines. Easements are herein dedicated for power and telephone utilities subject only to the approval of the subdivider. After such routes, serving any particular and all contiguous lots are established, 7'-6" easements shall be retained on each side of the centerlines of such utilities plus any additional easements necessary for maintaining such utilities (i.e., anchors, down guys, etc.) and the balance of power and telephone utility rights are automatically vacated. Fifteen foot water line easements are herein dedicated along all subdivision boundary lines, road right of lines and on each side of all other lot lines.
- Bearings established from Flecha Caida Ranch Estates No. 5, Book 12, Page 100.
- 3/4" iron pipe set at the P.C., P.T. & P.R.C. of all property line curves. 5/8" steel pins set at all other lot corners.
- Indicates standard Pima County survey monument set.
- Indicates curve, see curve data.

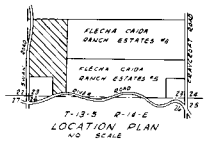

DEDICATION

We, the undersigned owners of the land shown on this plat hereby consent to the subdivision of said land in the manner shown hereon and hereby dedicate to the use of the public forever all streets and roads so designated on this plat together with 15' easements for utilities and services in the manner shown hereon.

TUCSON TITLE INSURANCE COMPANY, an Arizona corporation as Trustee under Trust Agreement No. 10179, and as mortgagee under Trust Agreement No. 10205.
By Victor M. David
Victor M. David, Trust Officer

STATE OF ARIZONA S.S.
COUNTY OF PIMA
This instrument was acknowledged before me this 2nd day of January, 1960 by Victor M. David as Trust Officer of the Tucson Title Insurance Company as Trustee.
Notary Public
My commission expires 11/1/52

APPROVALS

I hereby certify that this plat was approved by the Board of Supervisors, Pima County, Arizona on the 22nd day of March, 1960.

Edward J. Herrera 3-17-60
Clerk, Board of Supervisors Date

Walter A. Berg 3-25-60
County Engineer Date

I, Mary Fields, Clerk of the City of Tucson hereby certify that this plat was approved by the Mayor and Council of the City of Tucson on the 7th day of March, 1960.

Mary Fields 3-11-60
Clerk, City of Tucson Date

John W. Bender 3/8/60
City Engineer Date

Don J. King March 9, 1960
Chairman, City P. & Z. Comm. Date

John J. Jones 3-20-60
Exec. Secy. City P. & Z. Comm. Date

RECORDING DATA

STATE OF ARIZONA S.S.
COUNTY OF PIMA
No. 18865
Fee \$5.00
Filed for record at the request of John W. Bender on this 14th day of January, 1960, at 2:51 P.M. in Book 14 of Maps and Plats of Page 100 thereof.

Anna Sullinger
County Recorder
By Debra Jane Smith
Deputy

CERTIFICATION

I hereby certify that this plat represents a survey made under my direction and that all monuments exist as shown hereon.

W.K. Wheeler
Registered Professional Engineer

FLECHA CAIDA RANCH ESTATES #10

BEING A SUBDIVISION OF A PORTION OF THE W/2 OF THE SW 1/4 OF SECTION 25, T-3-S, R-14-E, G.B.S.R.B.M., PIMA COUNTY, ARIZONA.

MADDOCK & ASSOCIATES

SCALE 1"=100' SHEET 1 OF 2 JANUARY, 1960
158903

Book 14 Page 52

